

## Fact Sheet | Astrid Park Plaza – Antwerp

### Location

- Centrally located in the heart of the world famous diamond area, opposite the monumental Central Train Station & Zoo, near the bustling shopping areas De Keyserlei & Meir.
- The hotel is fully designed & decorated by the renowned, US born, architect Michael Graves.
- 100 metres from Central Station; terminal for train, bus & tram
- 10 minutes drive from Antwerp Airport Deurne
- 30 minutes drive from Brussels International Airport Zaventem

### Area Attractions

- Diamond district
- Rubens & Van Dijck museum
- Grote Markt
- In front of Antwerp's world famous Zoo
- New Diamond museum
- Antwerp harbour cruises
- Fashion museum
- Next to Aquatopia



## Guest Rooms and Other Facilities



- Four-star hotel
- 228 fully air-conditioned stylish rooms including superior & executive rooms, business & deluxe suites & a presidential suite
- Executive top floor with panoramic views of Antwerp
- Non smoking rooms & rooms for physically challenged guests
- Health Club with gym, indoor heated swimming pool, Jacuzzi, sauna, Turkish steam room, solarium & massage salon
- Private Parking

### Amenities & features for all guest rooms

- Internet access (via data port)
- In-house movie channel
- In-room safe
- Mini-bar

### Amenities & features for Executive Rooms & Suites

- Trouser press
- Coffee & tea making facilities
- Upgraded bathroom amenities
- Bath and separate shower
- 1 free welcome drink



## Restaurants and Bars

### “The Square” Restaurant, Brasserie & Terrace

The Square Brasserie  
Specializing in fresh flour tortilla wraps, assorted bagels & foccacia's all with a choice of delicious fillings.  
The Square Brasserie also offers a wide range of specialty coffee selections.  
The Square Brasserie boasts a spectacular view on the Astrid Square and the historic Central Station building through our versatile full-glass frontage which during the warm summer days can be fully opened for even more dining pleasure.

The Square Restaurant offers a slightly more formal atmosphere coupled with a spectacular themed menu of “East meets West”. Being influenced through the cooking styles of countries such as Japan, Thailand & China as well as the Mediterranean flavors of France, Italy and Spain.

- 24 hour Room Service

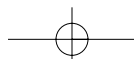

## Conference & Banqueting Room Capacities

Meeting Room	L x W (metres)	Height (metres)	Theatre	Boardroom	U-shape	Classroom	Dinner	Reception
Orlov 1	7.2 x 10	2.5	45	20	15	20	40	60
Orlov 2	4 x 7.2	2.5	15	10			10	
Orlov 3	8 x 13	2.5	60	25	20	30	40	70
Orlov 4	3.7 x 7.2	2.5	10	10		15		
Orlov 1+2	11 x 17	2.5	70	25	23	25	50	90
Orlov 1+2+3	19 x 30	2.5	100	30	35	50	90	160
Orlov 1+2+3+4	23 x 38	2.5	100	30	35	50	120	180
Sefadu 1	4 x 7.2	2.5		10				
Sefadu 2	4 x 7.2	2.5		10				
Condé 1	7.5 x 8	2.5	45	12		10	45	50
Condé 2	7.5 x 8	2.5	45	12		10	45	50
Condé 1+2	15 x 8	2.5	90	22		20	75	100
Scala 1	11.5 x 8.5	3.95	90	40	35	35	50	90
Scala 2	7 x 19	5.4	120	55	40	60	100	150
Scala 3	10 x 19	10.95	180	65	60	90	180	200
Scala 4	7.4 x 19	5.4	120	55	40	60	100	150
Scala 2+3+4	24.4 x 19	5.4	420		150	200	350	550
Scala 1+2+3+4	31 x 19	5.4	560		180	335	430	650
Victoria	3.85 x 8.5	3.95	24	14	16	16	25	30
Tiffany	3.85 x 8.5	3.95	24	14	16	16	24	30
Golden Madras	4.2 x 7.8	2.8	25	14	16	16	24	30
Blue Maharajah	4.2 x 7.8	2.8	25	14	20	16	24	30
Diamond Club	135 m2	5.4	100				70	120
Boardroom 8	3.5 x 6.3	2.5		12				

## Meetings and Events

Floor 1

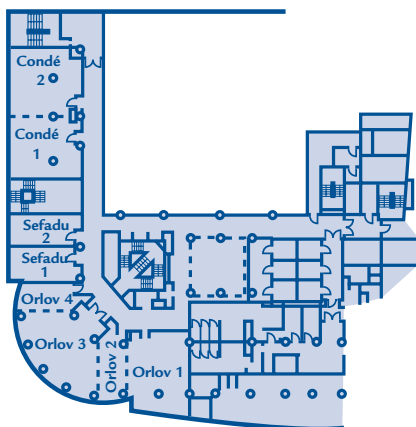

Floor 2

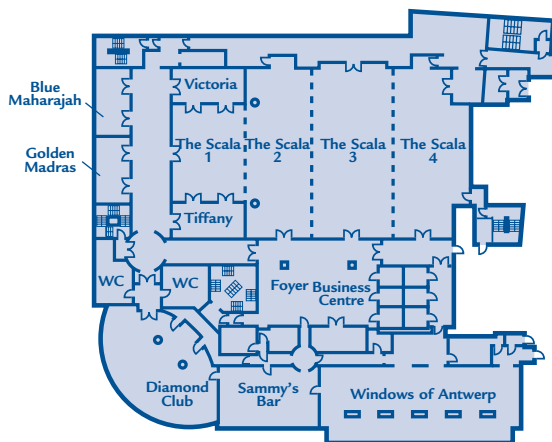

### Meeting facilities include

- 18 fully air-conditioned conference rooms, for meetings from 2 to 600 delegates
- Scala ballroom accommodating up to 600 delegates theatre style
- On site Business centre
- State-of-the-art audio-visual & technical equipment, including video conferencing, onsite
- The Diamond Club is the perfect venue for private functions. The Diamond Club can accommodate up to 120 delegates in reception style
- Sammy's Bar  
Exclusive private bar located on the 2nd floor overlooking the Astrid Square
- Astrid Lounge  
Exclude private boardroom on the executive floor (8th floor)
- Windows of Antwerp  
Restaurant combining splendid international cuisine with panoramic views of the monumental train station and the Astrid square



Koningin Astridplein 7, 2018  
Antwerp, Belgium  
T: +32 (0) 3 203 1234  
F: +32 (0) 3 203 1251  
www.parkplaza.europa.com

Reservations:  
T: +32 (0) 3 203 1273  
F: +32 (0) 3 203 1275  
appres@parkplazahotels.be  
GDS Chain Code: PK