

CONFERENCE FACILITIES

Lobby Level - Function / Meeting Rooms

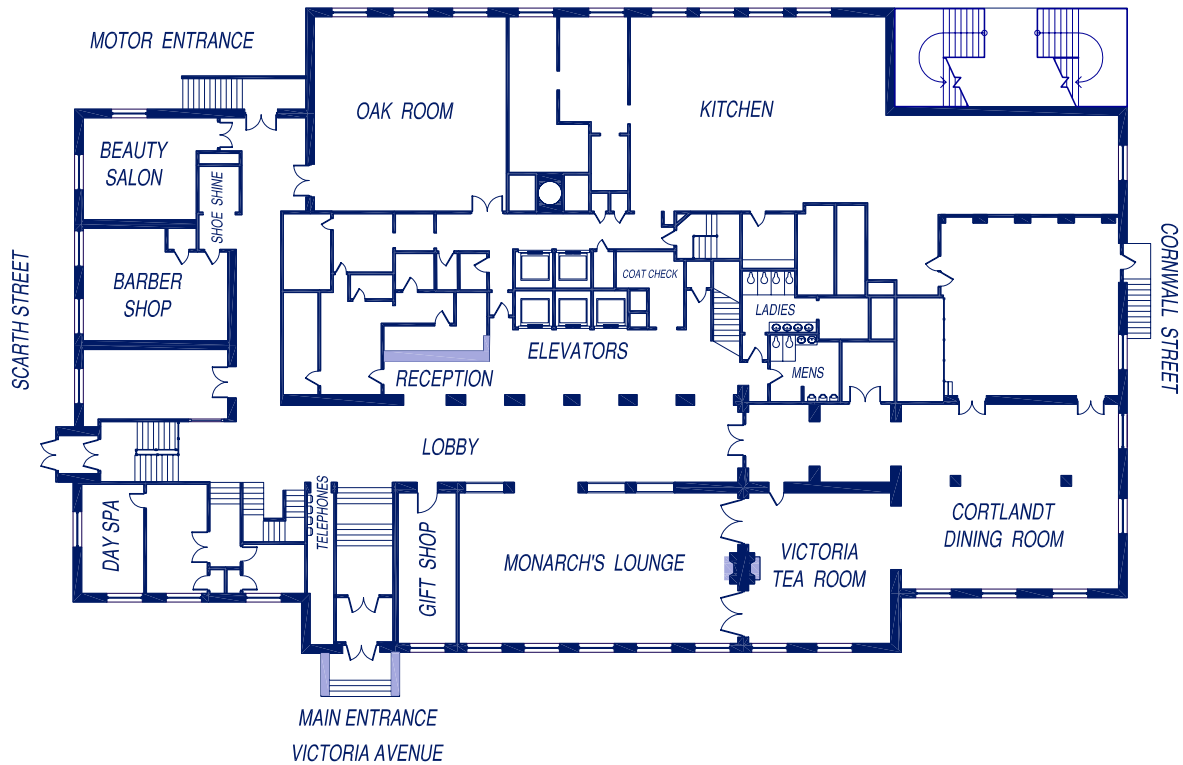

SEATING CAPACITY

* (H - indicates Hollow Square)

NAME		DIMENSIONS L X W X H	AREA sq.ft./m	SEATING CAPACITY								RATE PER 8 HOURS	
				CLASSROOM	THEATRE	T-SHAPE	U-SHAPE	BOARDROOM	BANQUET	DINE & DANCE	RECEPTION		
OAKROOM	ft.	40 x 33 x 12	1320				U - 40						
	m.	12.2 x 10.1 x 3.7	123.2	60	100	40	H - 40	40	70	60	100	\$235	
TEA-ROOM	ft.			30			U - 15						
	m.						H - 20	20	60		75	\$235	

* Room rentals negotiable and subject to change

General Information

Access

Loading area is located at the rear of the Hotel and leads directly to the service elevator, providing accessibility to all levels.

Electrical Power

Please advise us as to your specific electrical or telephone requirements in advance.

Office Services

Available through the catering office, photocopying, fax, secretarial service etc., all at a nominal fee.

Storage

As we have limited space for storage, please advise us well in advance so arrangements can be made.



HOTEL SASKATCHEWAN
Radisson

2125 Victoria Avenue, Regina, Saskatchewan, Canada S4P 0S3
Telephone (306) 522-7691 * Fax (306) 757-5521